

RAVADA GRAM PANCHAYAT
 TECHNICAL & URBAN ENGINEERING
 S.NO. 83, 3RD FLOOR, 2ND PART, 22ND CROSS, 22ND PART,
 22ND PART OF RAVADA VILLAGE BRACHAVALI WARD NO. 12,
 VIZIANAGARAM DISTRICT FOR RESIDENTIAL PLOTS.

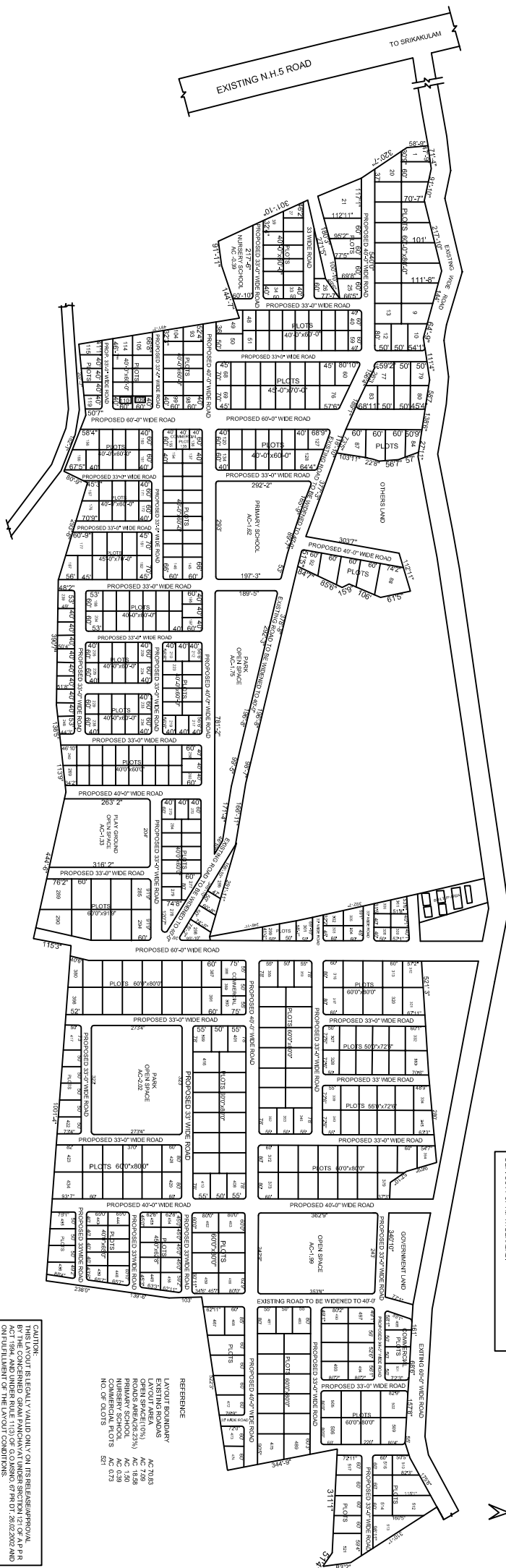

NOTE:-
 THE VILLAGE FALLS WITH IN EXTENDED LIMITS OF VUDA.
 THE PROPOSED ARE THE PROCESSED AS PER THE NORMS OF
 VUDA. THE VILLAGE FALLS WITH IN EXTENDED LIMITS OF VUDA.
 MEMO NO. 401/4422025-1, DT-25-08-2025 IN RAJAP
 DEPT/COVT OF AP/PHOSERABAD.



C.I.NO. - 1079250074
 CONFIRMED N.L.P.NO. 27/2008/
 REF.NO. 91820074/
 DT. 25-08-2025
 OF ROAD - VISANAGARAM

CAUTION:- THIS LAYOUT IS BEING VALID ONLY ON THE BASIS OF APPROVAL
 GRANTED BY THE AUTHORITY. ANY CHANGES IN THE LAYOUT OR
 ON THE BASIS OF THE LAYOUT CONDITIONS AND TRANSPORTATION
 AND TRANSPORTATION TO BE DONE BY THE USER.

ADJUDICATOR	TOWN PLANNING ASST.	DEPUTY DIRECTOR
JOINT DIRECTOR (M&P) BARCH, F.I.LL, DIP, 150P, AATPIL DIRECTOR OF TOWN & COUNTRY PLANNING GOVT OF ANDHRA PRADESH, HYDRABAD		

REFERENCE
 LAYOUT INQUIRY
 EXISTING ROADS
 LAYOUT AREA
 ROAD WIDENING
 ROAD WIDENING
 PRIMARY SCHOOL
 NO. OF PLOTS
 AC 70.83
 AC 10.58
 AC 1.50
 AC 0.38
 AC 1.19
 281